

S2083A Assembly Guide

Before Assembling:

1. Please check the accessory list before assembly. Contact your local dealer if you find any parts missing.
2. Please read through the assembly guide.

M.2 SSD Accessory Package

- | | | |
|--|---|----------------------|
| (1)M3x3 Screw *1pc
P/N: 13MISW00010M11 |  | [for M.2 (2280) SSD] |
| (2)M3x5 Screw *1pc
P/N: 13MISW00005M11 |  | [for M.2 NGFF SSD] |
| (3)M3 Nut *1pc
P/N: 13MINU00002M11 |  | [for M.2 NGFF SSD] |
| (4)Copper Nut /H: 1.45mm *1pc
P/N: 13MICA00001M05 |  | [for M.2 NGFF SSD] |

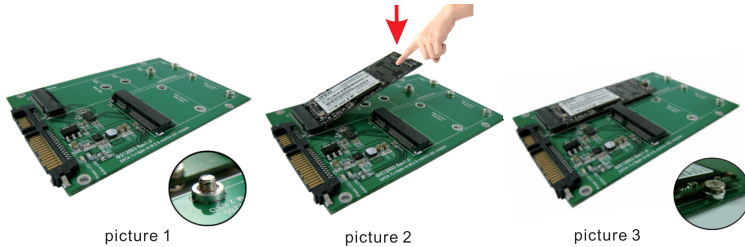

Step 1: Put copper nut on the same side of the NGFF connector; and fix M3x5mm screw from bottom to top of the adapter.

Step 2: Insert M.2 NGFF SSD into M.2 67pin socket. Press down M.2 NGFF SSD and aim to the copper nut hole.

Step 3: Using M3 nuts to fix M.2 NGFF SSD on the adapter namely complete the installation.

If your M.2 NGFF SSD is 2280 form factor, pls ignore step 1. Use M3 x 3 Screw to fix M.2 NGFF SSD.

mSATA SSD Accessory Package

- | | | |
|--|---|---------------------|
| (1)M2x3 Screw *3pcs
P/N: 13MISW00005M11 |  | [for Full size SSD] |
| (2)M2x6mm(H) screw *3pcs
P/N: 13MISW00001M11 |  | [for Half size SSD] |
| (2)Copper Nut /H: 4.0mm *3pcs
P/N: 13MICA00001M05 |  | [for Half size SSD] |
| (3)M2 nut *3pcs
P/N: 13MINU00001M11 |  | [for Half size SSD] |

The above accessories parts are all have extra 1pc for spare part.

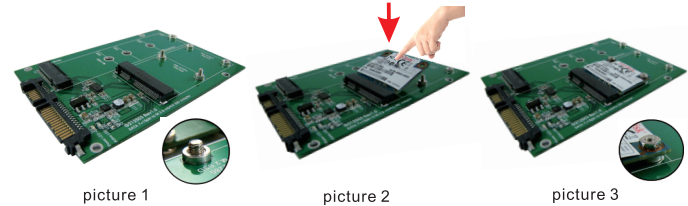

Step 1: Put 2pcs of copper nuts(3) on the holes for the half size mSATA SSD and fix with 2pcs of M2x6mm(2) screws. Insert mSATA SSD into mini PCI-e socket.

Step 2: Press mSATA SSD down and aim to the copper nuts below.

Step 3: Fix mSATA SSD on the adapter with 2pcs of M2*3 screws.

Features

- 2.5" SATA SSD Form Factor : 98 x 65.5mm
- M.2 (NGFF) & mSATA to SATA III Module
- Build in Mini PCI-e 52pin Female connector
- Build in M.2 (NGFF) B key Female connector
- Green LED indicates power status
- Red LED indicates active status
- Insert both M.2 & mSATA SSD on S2083A, M.2 SSD is the first priority. mSATA won't work.