

AD906A Assembly Guide

Before Assembling:

1. Please check the accessory list before assembly. Contact your local dealer if you find any parts missing.
2. Please read through the assembly guide.

Accessory Package

(1)M3x5 Screw *1pc
P/N: 13MISW00005M11



[for M.2 NGFF SSD]

(2)M3 Nut *1pc
P/N: 13MINU00002M11



[for M.2 NGFF SSD]

(3)Copper Nut /H: 1.45mm *1pc
P/N: 13MICA00001M05



[for M.2 NGFF SSD]

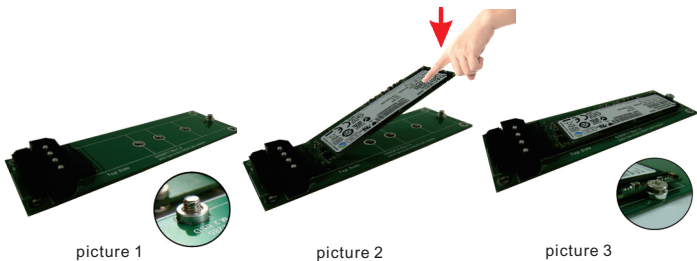

Step 1: Put copper nut on the same side of the NGFF connector;
and fix M3x5mm screw from bottom to top of the adapter.(picture 1).

Step 2: Insert M.2 NGFF SSD into M.2 67pin socket. Press down M.2 NGFF
SSD and aim to the copper nut hole.(picture 2)

Step 3: Using M3 nuts to fix M.2 NGFF SSD on the adapter (picture 3),
namely complete the installation.